

Piston rod cylinder ▶ Mini cylinder

Mini cylinder, Series ICM

- ▶ Ports: M5 - G 1/8 ▶ Single-acting, retracted without pressure ▶ cushioning: elastic ▶ corrosion-resistant
- ▶ with integrated rear eye ▶ Piston rod: external thread ▶ suitable for use in food processing



P132_042_c

Compressed air connection	Internal thread
Working pressure min./max.	2.5 bar / 10 bar
Ambient temperature min./max.	-20 °C / +70 °C
Medium temperature min./max.	-20 °C / +70 °C
Medium	Compressed air
Max. particle size	50 μm
Oil content of compressed air	0 mg/m ³
Pressure for determining piston forces	6,3 bar

Materials:	
Cylinder tube	Stainless steel
Piston rod	Stainless steel
Front cover	Polyoxymethylene
End cover	Polyoxymethylene
Connection thread	Stainless steel
Seal	Acrylonitrile Butadiene Rubber
Nut for cylinder mounting	Polyamide
Nut for piston rod	Stainless steel
Scraper	Polyurethane
Lubricant	ISO 21469 (NSF-H1)

Technical Remarks

- The pressure dew point must be at least 15 °C under ambient and medium temperature and may not exceed 3 °C.
- The oil content of compressed air must remain constant during the life cycle.
- Use only the approved oils from AVENTICS, see chapter „Technical information“.
- Nut MR3 included in supply

Piston Ø	[mm]	8	10	12	16	20
Extracting piston force	[N]	26	40	58	90	136
Spring force min. - max.	[N]	4 - 6	6 - 9	7 - 13	24 - 37	28 - 62
Stroke max.	[mm]	25	25	25	25	25

Piston Ø	[mm]	25				
Extracting piston force	[N]	250				
Spring force min. - max.	[N]	28 - 62				
Stroke max.	[mm]	25				

	Piston Ø	8	10	12	16	20
	Piston rod thread	M4	M4	M6	M6	M8
	Ports	M5	M5	M5	M5	G 1/8
	Stroke 25	1326108020	1326110020	1326112020	1326116020	1326120020
	Piston Ø	25				
	Piston rod thread	M10x1,25				
	Ports	G 1/8				
	Stroke 25	1326125020				

Weight [kg]	Piston Ø	8	10	12	16	20
	Stroke 25	0.043	0.046	0.072	0.08	0.14
	Piston Ø	25				
	Stroke 25	0.18				

Piston rod cylinder ▶ Mini cylinder

Mini cylinder, Series ICM

- ▶ Ports: M5 - G 1/8 ▶ Single-acting, retracted without pressure ▶ cushioning: elastic ▶ corrosion-resistant
- ▶ with integrated rear eye ▶ Piston rod: external thread ▶ suitable for use in food processing

Dimensions

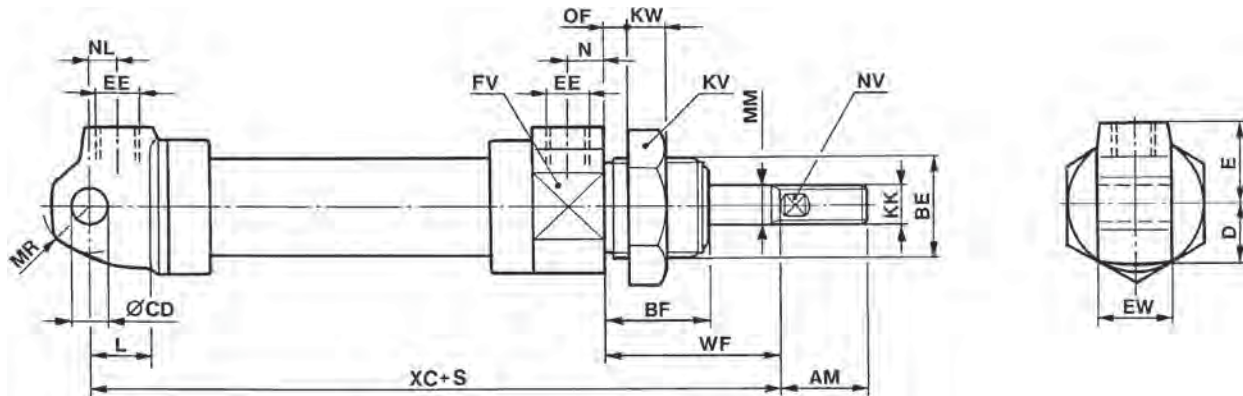

D132_005

S = stroke

Piston Ø	AM +0 -2	BE	BF	CD H11	D	E	EE	EW d13	FV	KK	KV	KW
8	12	M12x1,25	14	4	7.5	12	M5	8	14	M4	17	7
10	12	M12x1,25	14	4	8	12	M5	8	16	M4	17	7
12	16	M16x1,5	20	6	10	13.5	M5	12	20	M6	24	7
16	16	M16x1,5	20	6	12	14	M5	12	24	M6	24	7
20	20	M22x1,5	22	8	15	18	G 1/8	16	30	M8	30	8
25	27	M22x1,5	22	8	17	18	G 1/8	16	34	M10x1,25	30	8

Piston Ø	L	MM	MR	N	NL	NV	OF 1)	WF ±1,2	XC ±1				
8	7	4	5	5	12	3	4.5	16	114				
10	7	4	5	5	12	3	4.5	16	114				
12	9	6	7.5	5	7	4	10	22	112				
16	9	6	7.5	5	6	4	10	22	108				
20	12	8	10	8	7	6	10	24	123				
25	12	10	10	8	6.5	8	10	23	127				

1) Max.