

## Series BEK

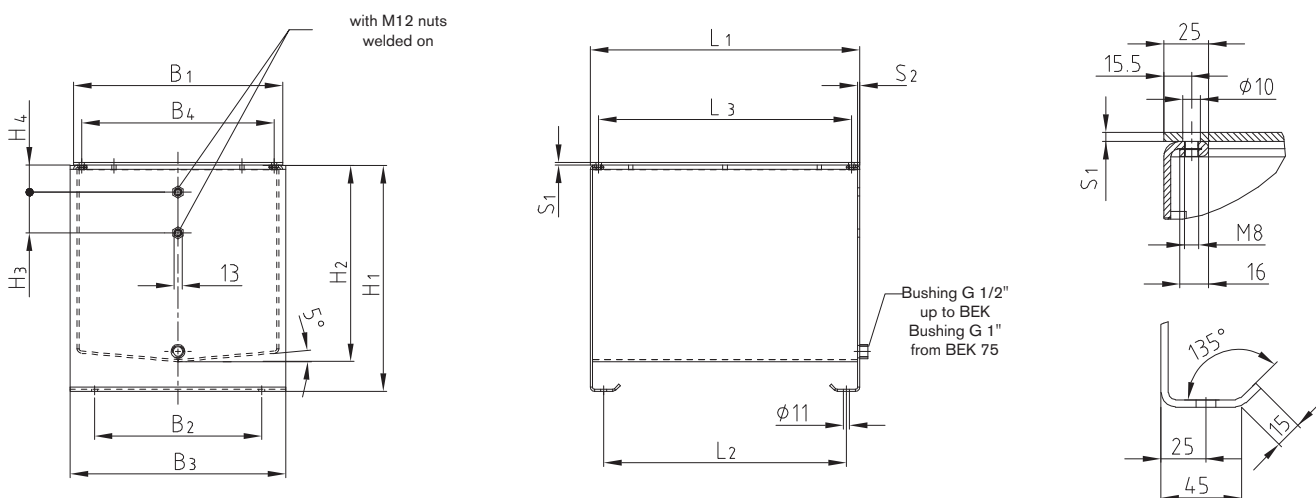

Series BEK, NG 12-300													
Order description	Effective vol.	Weight	Tank dimensions [mm]										Tank complete available from stock
			L <sub>1</sub>	L <sub>2</sub>	B <sub>1</sub>	B <sub>2</sub>	B <sub>3</sub>	H <sub>1</sub>	H <sub>2</sub>	H <sub>3</sub>	H <sub>4</sub>	S <sub>2</sub>	
NG	Liter	kg	L <sub>1</sub>	L <sub>2</sub>	B <sub>1</sub>	B <sub>2</sub>	B <sub>3</sub>	H <sub>1</sub>	H <sub>2</sub>	H <sub>3</sub>	H <sub>4</sub>	S <sub>2</sub>	
BEK 12	16	17	310	260	298	220	310	275	220	76	50	4	●
BEK 20	26	23	400	350	298	220	310	325	270	76	50	4	●
BEK 35	40	30	470	420	298	220	310	400	345	76	50	4	●
BEK 50	58	40	500	450	388	310	400	420	365	76	50	4	●
BEK 60	69	43	550	500	388	310	400	445	390	76	50	4	●
BEK 75	85	46	550	500	388	310	400	530	475	127	50	4	●
BEK 100	109	54	700	650	388	310	400	530	475	127	50	4	●
BEK 150	175	79	750	700	488	410	500	620	565	127	80	4	●
BEK 225	267	115	900	850	588	510	600	650	595	127	80	4	●
BEK 300	339	127	900	850	688	610	700	700	645	127	80	4	●

● = Standard programme available from stock and in short term

Ordering example:	BEK	100	E
	KTR standard tank	Tank size	Cover design "E"

## Tank cover

### Cover design E

up to size 75

as from size 100

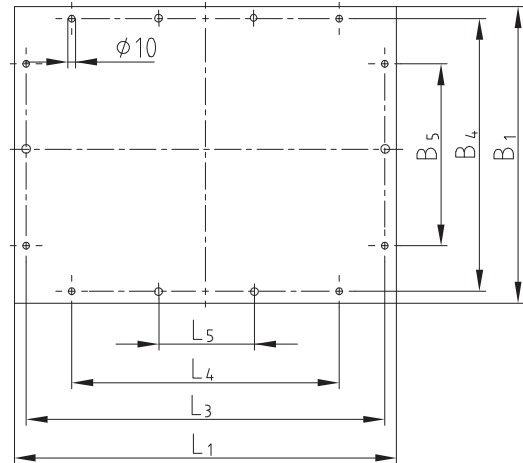
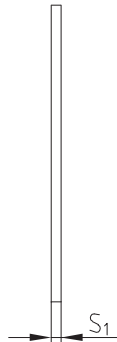
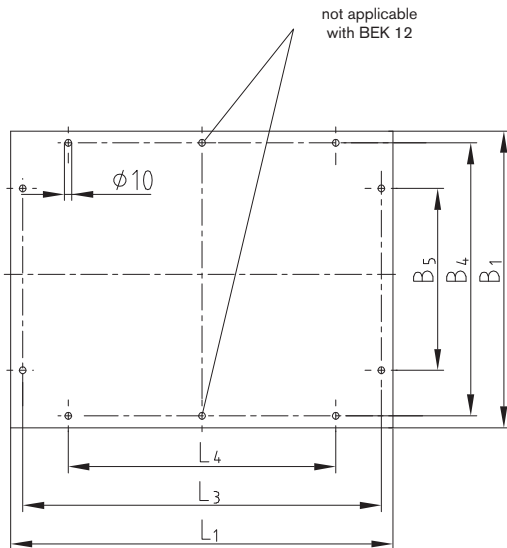

Cover design „E“								
NG	Dimensions [mm]							
	S <sub>1</sub>	L <sub>1</sub>	B <sub>1</sub>	L <sub>3</sub>	B <sub>4</sub>	L <sub>4</sub>	B <sub>5</sub>	L <sub>5</sub>
12	4	310	298	279	267	160	148	-
20	4	400	298	369	267	250	148	-
35	5	470	298	439	267	320	148	-
50	5	500	388	469	357	350	238	-
60	5	550	388	519	357	400	238	-
75	5	550	388	519	357	400	238	-
100	6	700	388	669	357	550	238	184
150	6	750	488	719	457	600	338	200
225	8	900	588	869	557	750	438	250
300	8	900	688	869	657	750	538	250