

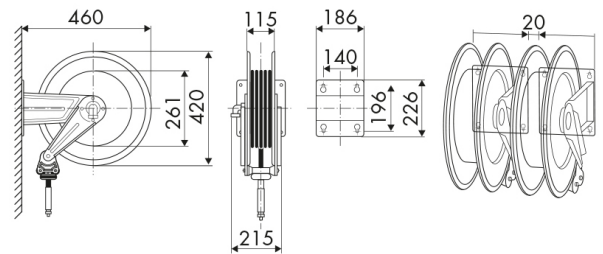

ART. 8430.104

Fixed hose reel, s.430, for air-water, 20 bar, with black rubber hose 15 m, \varnothing 1/2"



Features

Pressure
Compatible fluids
Swivel joint
Seals
Characteristic
Material
Couplings
Hose
 \varnothing and hose length
Inlet
Outlet
Reel flow path

Value

20 bar
air - water
brass
Viton®
fixed
painted steel
zinc plated steel
p/n 996.215
 \varnothing 1/2" - 15 m
G 1/2" (f)
G 1/2" (m)
brass - zinc plated steel

RAASM S.p.A.

via Marangoni 33, 36022 - S. Zeno di Cassola (VI) - ITALY
Tel. 0039 0424 571111 - Fax. 0039 0424 571135

info@raasm.com - www.raasm.com

Copyright © 2020 All rights reserved to RAASM S.p.A.