

## Rubrik 13.20

### BSP Female Thread DIN ISO 228 POM - NBR

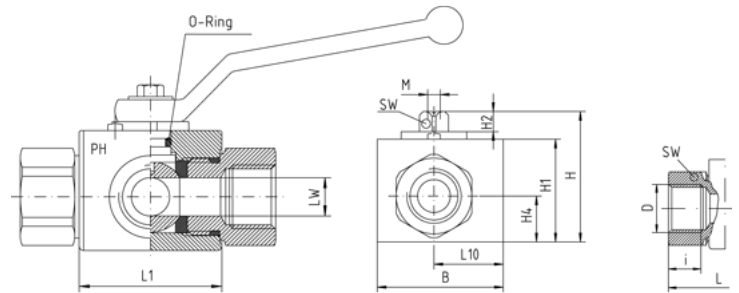
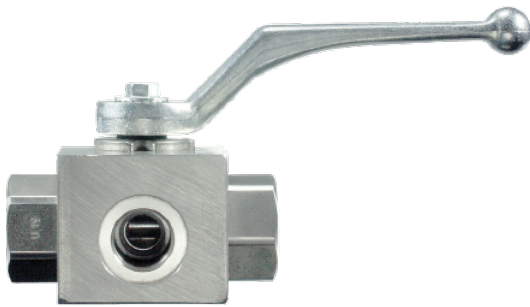

L-Bore

Series 100

DN 4 to DN 50

Body, Ball and Stem, V4a (AISI 316)

Each PH ball valve is subject to an inspection for resistance, sealing and special characteristics.

Inspection control certificates 3.1 B or 3.1 C per DIN EN 10204 can be supplied on request against invoice.

Ball Sealing: POM

Stem Sealing: NBR

Hydraulics - Standard Version

-20°C to 100°C

The indicated working pressure PB is only valid for the standard version 4423.

Max. allowed pressure (PB) see at the data from the compression couplings.

Measurements subject to alteration.

		Pressure	Thread	Approx. Dimensions mm												Order-Code
DN	LW	PB	D	B	H	H1	H2	H4	i	L	L1	L10	M	SW	SW*	
4	5,0	400	G 1/8"	40	46,5	35	8,0	16,0	9	69	35	26,0	M 5	22	9	BK3-G-1/8"-4423-LA
6	6,0	400	G 1/4"	40	46,5	35	8,0	16,0	12	69	35	26,0	M 5	22	9	BK3-G-1/4"-4423-LA
10	9,0	400	G 3/8"	45	51,5	40	8,0	18,0	12	73	42	28,0	M 5	27	9	BK3-G-3/8"-4423-LA
13	11,5	400	G 1/2"	50	56,0	40	8,0	17,0	14	85	47	32,0	M 5	30	9	BK3-G-1/2"-4423-LA
20	18,0	320	G 3/4"	65	73,5	57	12,0	24,5	17	96	61	40,5	M 6	41	14	BK3-G-3/4"-4423-LA
25	22,0	350	G 1"	80	81,5	65	12,0	30,0	19	113	63	51,0	M 6	46	14	BK3-G-1"-4423-LA
32	30,0	350	G 1 1/4"	100	99,0	80	13,5	38,0	20	110	78	62,0	M 8	60	17	BK3-G-1 1/4"-4423-LA
40	35,0	250	G 1 1/2"	105	109,0	90	13,5	42,0	24	120	85	65,0	M 8	70	17	BK3-G-1 1/2"-4423-LA

50	44,0	250	G 2"	120	139,0	120	13,5	62,0	28	140	100	72,0	M 8	85	17	BK3-G-2"-4423-LA
----	------	-----	------	-----	-------	-----	------	------	----	-----	-----	------	-----	----	----	------------------