

Rubrik 13.15

BSP Female Thread DIN ISO 228 POM - NBR

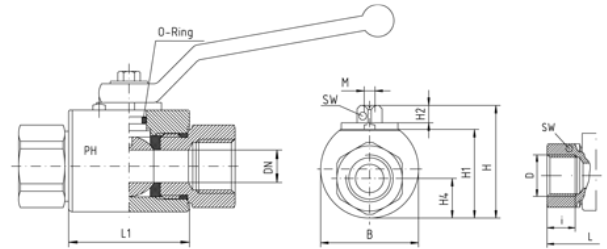
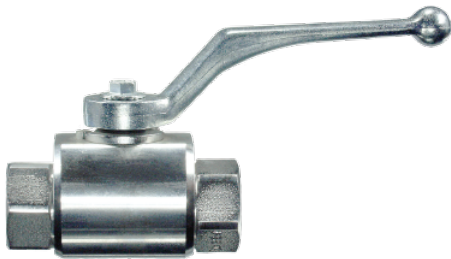

Series 020 (DN 5 bis DN 50)

Body, Connecting Parts, Ball and Stem Stainless Steel, V4a (AISI 316)

Each PH ball valve is subject to an inspection for resistance, sealing and special characteristics.

Inspection control certificates 3.1 B or 3.1 C per DIN EN 10204 can be supplied on request against invoice.

Other materials as 254Smo or Hastelloy, etc. on request.

Ball Sealing: POM

Stem Sealing: NBR

Corrosive Media

-20°C to 100°C

The indicated working pressure PB is only valid for the standard version 4423.

Max. allowed pressure (PB) see at the data from the compression couplings.

Measurements subject to alteration.

Weight		Pressure	Thread	Approx. Dimensions mm											Order-Code
kg	DN	PB	D	B	H	H1	H2	H4	i	L	L1	M	SW	SW*	
0,35	5	500	G 1/8"	35	43,5	32	8,0	13,0	9	69	36	M 5	22	9	RKH-G 1/8"-4423
0,35	6	500	G 1/4"	35	43,5	32	8,0	13,0	12	69	36	M 5	22	9	RKH-G 1/4"-4423
0,5	10	500	G 3/8"	42	49,5	38	8,0	16,5	12	73	43	M 5	27	9	RKH-G 3/8"-4423
0,65	13	500	G 1/2"	45	51,5	40	8,0	17,5	14	85	48	M 5	30	9	RKH-G 1/2"-4423
0,75	16	400	G 5/8"	50	62,0	46	12,0	19,0	14	84	48	M 6	32	12	RKH-G 5/8"-4423
1,5	20	400	G 3/4"	60	73,0	57	12,0	24,5	17	96	62	M 6	41	14	RKH-G 3/4"-4423
1,8	24	400	G 1"	65	79,0	63	12,0	28,0	19	113	66	M 6	46	14	RKH-G 1"-4423

3,8	32	350	G 1 1/4"	90	104,0	84	13,5	38,0	20	110	81	M 8	60	17	RKH-G 1 1/4"-4423
6,1	38	350	G 1 1/2"	100	112,0	93	13,5	42,5	22	120	86	M 8	70	17	RKH-G 1 1/2"-4423
9,1	48	350	G 2"	120	131,0	111	13,5	50,0	28	140	101	M 8	85	17	RKH-G 2"-4423